

DC MOLD SILENT 92X32

3.62sq.X1.3 (92sq.X32)



SKLD series



Leads specification : UL 1007 AWG24

DIMENSIONS : inch (mm)

- Lead wire type (Weight : 150g (0.3 lb))

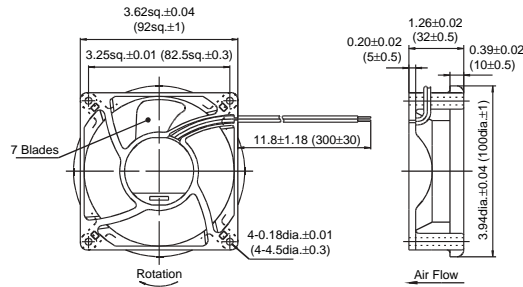

- Hole Cutting Size. (For reference) (Outlet only)

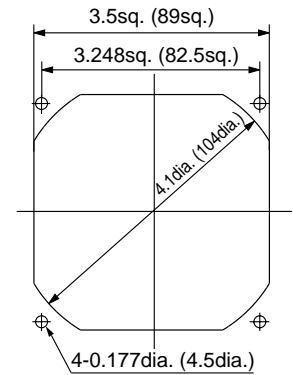

AIR PERFORMANCE

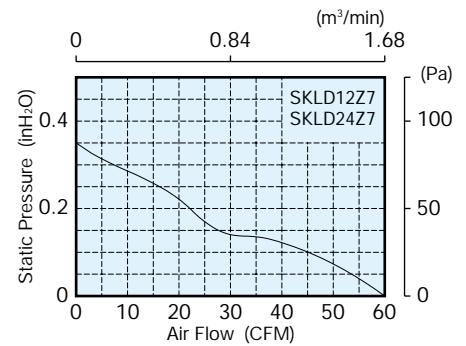
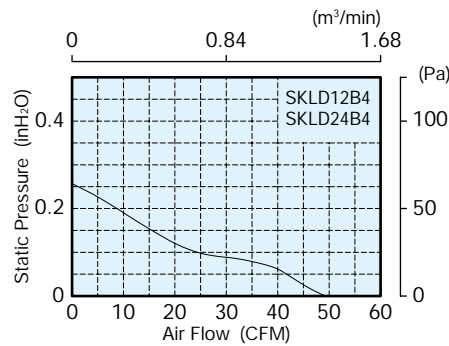

SPECIFICATION

Max. air flow		Max. static pressure			Noise	Speed	Input	Voltage		Current	Model code	Operating temperature	
m ³ /min	CFM	Pa	mmH ₂ O	inH ₂ O				dB(A)	r/min			W	V
1.7	60	86	8.8	0.35	41	3800	4	12	7.2 - 13.8	340	SKLD12Z7	-20 ~ +60	-4 ~ +140
							3.6	24	12 - 27.6	150	SKLD24Z7		
1.5	53	65	6.6	0.26	35	3200	3.5	12	7.2 - 13.8	280	SKLD12B4	-20 ~ +70	-4 ~ +158
								24	12 - 27.6	140	SKLD24B4		